

CHECK CONDITION OF SHIPMENT

Upon receipt of this kit, check the condition of the packaging. Damage to the package should be noted on the carrier's freight receipt. Any damage claims as a result of shipping must be handled through the shipper. Travis Industries will provide assistance in resolving shipping claims or replacing items not included in the package. Please report any missing items immediately.

COMPATIBILITY

- All Travis Gas Stoves & Inserts
- Newport (Avanti) Pellet Stoves & Inserts
- Pioneer (Heritage Bay) Pellet Stoves & Inserts

ITEMS NEEDED FOR ASSEMBLY

- Standard Screwdriver
- Additional tools may be required for laying the thermostat wire
- You may need additional tools to access the on/off switch on certain gas heaters - refer to the instructions in the owner's manual.

PACKING LIST

- Thermostat
- Thermostat wire (25' long)
- 2 Screws (for attaching the thermostat to wall)

INSTALLATION INSTRUCTIONS

! This kit must be installed by a qualified technician.

! Do not connect 110 VAC to the gas control valve or on/off switch on gas heaters or the thermostat posts on pellet heaters.

Gas Heater Installation

- (a)** Remove the on/off wire on the lower post of the on/off switch and attach it to the upper post.

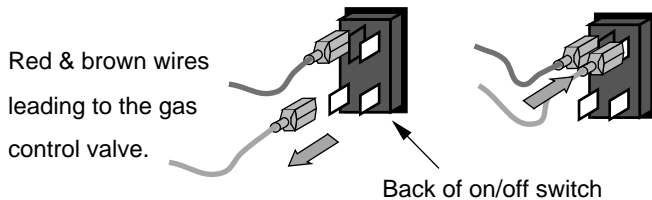

- (b)** Connect the thermostat wires to the lower two posts on the on/off switch (orientation does not matter).

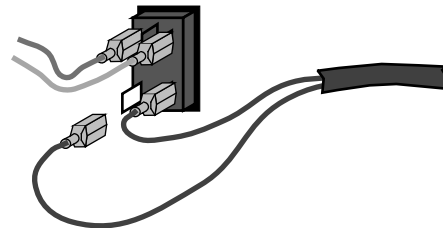

Pellet Heater Installation

Attach the thermostat wire to the circuit board.

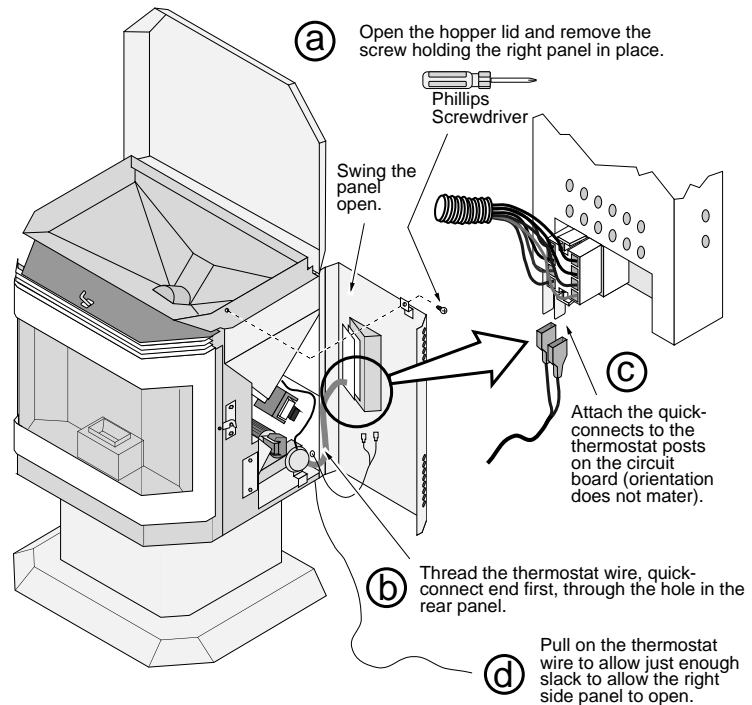

Thermostat Placement and Installation

- 1 Determine a location for the thermostat that is within range of the 20' length of thermostat wire. It should be centralized in the room and away from the heater. The wire may be routed externally on the wall or behind the wall (preferred). Run the thermostat wire to this location. Use nylon ties, if necessary to keep the wire from contacting any hot portions of the heater.
- 2 Follow the directions below to attach the thermostat and thermostat wires.

