



Fan, DVS F/S GS

Installation Instructions (sku 99000159)

Packing List

- Blower Assembly
- Wiring Harness
- Rheostat
- Snap Disc
- Rheostat Nut and Knob
- Mounting Hardware - Stud Plate, (2) Grommets, (2) Bushings, (2) Washers, (2) Nuts

Installation

WARNING: Make sure power to the stove has been shut off prior to installation (disable the service breaker).
Do not connect 110-120 VAC to the gas control valve or wiring system of this fireplace.

HINT: It is easier to install the blower prior to connecting the gas line or installing the stove. If using the Greensmart™ remote, install it after the blower is in place.

- 1 Loosen the bottom panel attachment screws (there are two on each side see Figure 1). Slide the bottom panel back and place it below the stove (see Figure 2). This allows for quick access to the controls under the stove.



Figure 1



Figure 2

- 2 Remove the cover plate behind the gas control valve used to conceal the hole for the snap disc (see Figure 3). Attach the included snap disc in this location(see Figure 4).



Figure 3



Figure 4



Fan, DVS F/S GS

Installation Instructions (sku 99000159)

- Place the blower near the back of the stove and attach the two wires on the wiring harness labeled "BLOWER" to the blower (orientation does not matter – see Figure 5). Attach the two wires labeled "SNAP DISC" to the snap disc (orientation does not matter – see Figure 6).

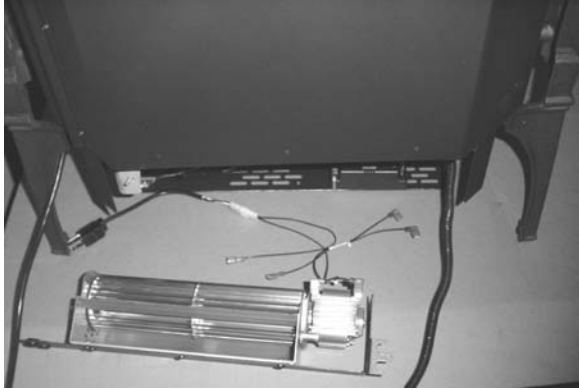

Figure 5



Figure 6

Special Instructions for GreenSmart™ Remote

If using the Greensmart™ remote, the rheostat will be bypassed and the power connected to the fan extension module (see instructions below for details).

Bypassing the Rheostat – Disconnect and discard the electrical line that leads from the snap disc to the rheostat (carefully remove the wire tie and "SNAP DISK" label from the wiring harness – see Figure 7 "a"). Attach the lead from the power input to the snap disc (see Figure 7 "b"). Attach the wiring harness molex to the power lead (included with the remote – see Figure 7 "c"). Then plug the power lead into the outlet labeled "FAN" on the fan control module. Disregard the instructions for installing the rheostat (steps 6 through 9) or attaching power to the wiring harness (step 4).

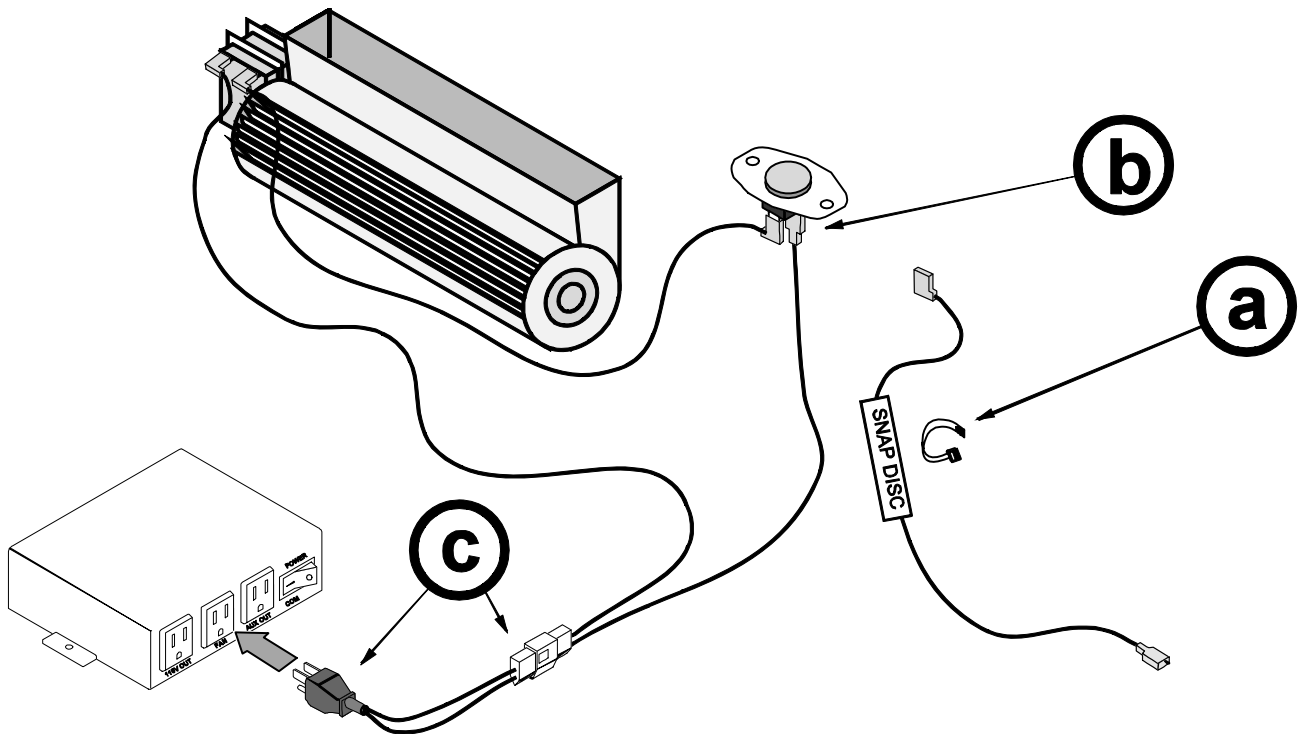

Figure 7



Fan, DVS F/S GS

Installation Instructions (sku 99000159)

- 4 Plug the power cord on the wiring harness into the receptacle on the stove (see Figure 8).



Figure 8

- 5 Install the blower (see Figure 9).

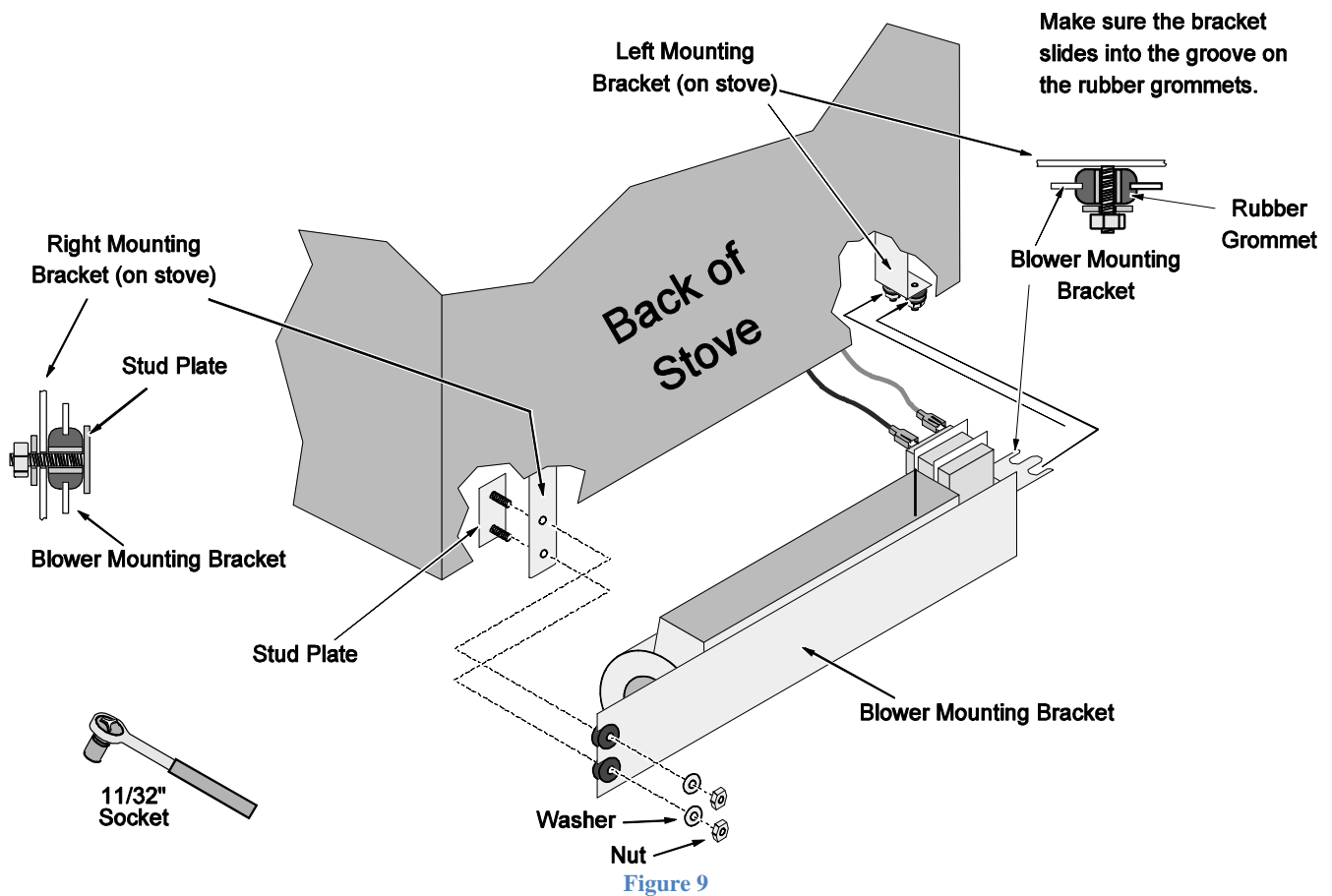

Figure 9



Fan, DVS F/S GS

Installation Instructions (sku 99000159)

- 6 Remove the four screws holding the control panel to the front of the stove (see Figure 10). Carefully remove the control panel, making sure you do not disconnect any wiring (see Figure 11).



Figure 10

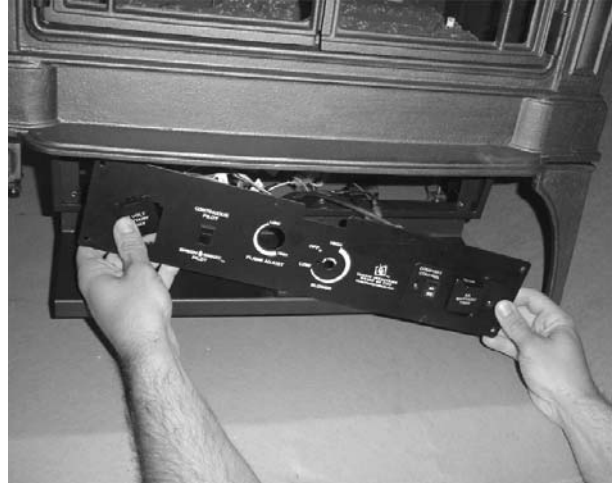

Figure 11

- 7 Connect the leads on the rheostat to the wires marked "RHEOSTAT" on the wiring harness (see Figure 12).

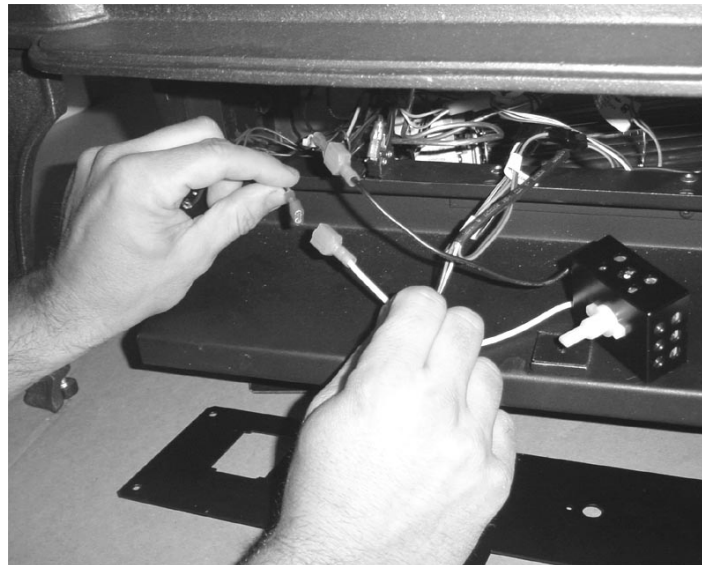

Figure 12



Fan, DVS F/S GS Installation Instructions (sku 99000159)

- 8 Insert the shaft on the rheostat through the control panel. Make sure the orientation-tab on the rheostat lines up with the orientation-hole on in the control panel. Secure the rheostat using the press nut (see Figure 13). Place the rheostat knob on the rheostat (see Figure 14).



Figure 13



Figure 14

- 9 Re-attach the control panel, making sure no wiring is pinched or damaged.
- 10 Before re-attaching the bottom panel, verify that all wiring is secure and does not contact any moving or hot surfaces. Use wire ties, if necessary, to secure the wiring. Replace the bottom panel and return the stove to the correct configuration.