



TRAVIS INDUSTRIES
HOUSE OF FIRE

616 / 430 GSR Face Installation Instructions

| 616 Faces | | | 430 Faces | |
|-------------------------|---------------------------|--------------------------|-------------------------|--------------------------|
| Wilm Black 96900221 | Rect Bevel Black 96900752 | Times Square 96900761 | Wilm Black 96800207 | Times Square 96800706 |
| Wilm Carbon 96900222 | Universal 96900755 | Profile Black 96900763 | Wilm Carbon 96800208 | Profile Black 96800708 |
| Wilm Carbon 96900223 | Shadowbox Blk 96900757 | Profile Stnls 96900765 | Shadow Black 96800703 | Profile Stnls 96800709 |
| Shadowbox Blk 96900750 | Shadowbox Brnz 96900758 | Profile Ant Cop 96900766 | Shadow Bronze 96800704 | Profile Ant Cop 96800710 |
| Shadowbox Brnz 96900751 | Rect Bevel Blk 96900759 | Profile Pnt Brz 96900767 | Rect Bevel Blk 96800705 | Profile Pnt Brz 96800711 |

Packing List

- Face
- All Faces Except Shadowbox:
 - Light Shield (see picture below)
 - (2) #10 x 3/8" Screws
- Wilmington Faces:
 - Cove Covers
- Wilmington Carbon Faces:
 - Patina Touch-Up Kit (with instruction sheet)



Light Shield Installation (Applies to all faces except Shadowbox)

IMPORTANT: Install the light shield before installing the insert into the fireplace.

The light shield prevents light from the upper accent light from exiting the grill.

1. Remove the glass from the insert.
2. Attach the light shield to the insert with the two included screws using a 5/16" nutdriver.

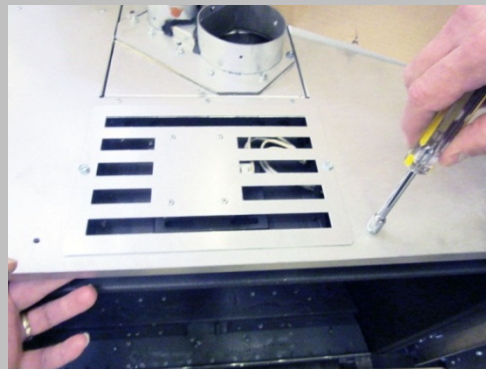
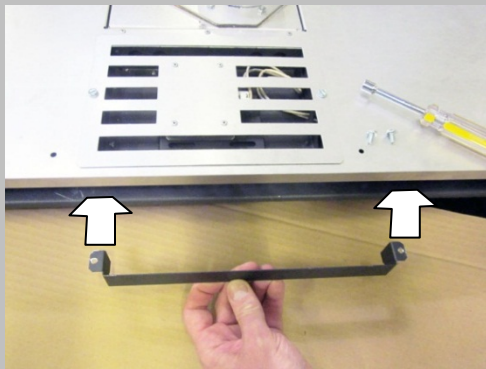

616 / 430 GSR Face Installation Instructions

Wilmington Faces Only

Attach the cove cover to the glass frame as shown below.

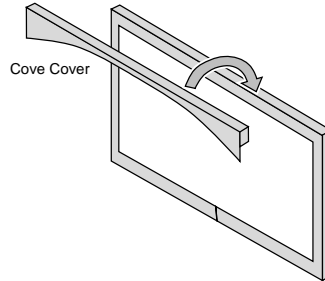

Face Installation

The insert should be in place with the surround panel installed. See the manual for details.

1. Insert the 2 lower tabs on the face into the 2 slots on the glass frame.
2. Press forward and up on the face until the upper tabs insert into the upper slots on the glass frame. Then the face will slide down securely. See the photos below.



Stainless Steel / Copper – Care and Cleaning

Use glass cleaner on a soft cloth to remove any marks left on the surface.